

Developers
SIGNUM
LIVE ONCE, LIVE SIGNUM

Jai Vinayak Group™
BUILDING MAGICAL MOMENTS

Member of
CREDAI
BENGAL

Signum Sales:
9835 180 180
customercare@signumgroup.in

Land Owners

GOLDEN EARTH
Swastika
ELEVATING LIVES

Rituraj Constructions LLP

Correspondence Address: 3A, Auckland Place, 10th Floor, Unit 10B Kolkata 700 017 | **Ph. :** 98747 67800

Site Address: 76/1F B T Road, Agarpara, Tetultala, Kolkata 700 056

www.signumgroup.in / www.jaivinayakgroup.com

The entire project is being developed in phases

WB HIRA REGISTRATION NO.

PHASE - xxxxxxxxxxxxxxxxxxxxxxxxx | hira.wb.gov.in

PHASE - xxxxxxxxxxxxxxxxxxxxxxxxx

Disclaimer: 1)The photographs used are an artist's impressions for illustration purposes only and may not bear resemblance to the actual feature / offerings. 2)This is not intended to create any legal obligation on any party. This only describes the concept of the project. The images and details mentioned in this document are tentative and subject to change/variation, addition/alterations at the sole discretion of the developer, architect and/or appropriate authorities or as may be made by the developer keeping in mind extant/proposed laws, rules and regulations



SAMPURNA
A COMPLETE LIFE



A HOME BLESSED WITH
SHOLOKALA

Step into a complete home, reflecting the 16 kalas
(16 facets) of wholesome joy, well being, and comfort.
Experience Sampurna - the happy abode it brings to you
by integrating the ideas of all the 16 kalas into your
daily life in here!

SAMBHAVANA

SWABHIMAN

SOUNDARYA

SANSKRITI

SHANTI

SUSWASHTHYO

SUKH

SAUHARDYA

SANSKAR

SHOISHOB

SAMRIDDHI

SHOUKHINOTA

SACHHANDYA











SADHINATA

SAMPORKO

SREEJONI



LANDSCAPE

-  Water Body[#]
-  Cricket Pitch^{*}
-  Senior Citizen seating corner[#]
-  Flower Garden^{*}
-  Adda Zone^{*}
-  Landscaped Garden^{*}
-  Yoga Lawn^{*}
-  Reflexology Walkway^{*}
-  Holy Plantation^{*}
-  Open area board game[#]

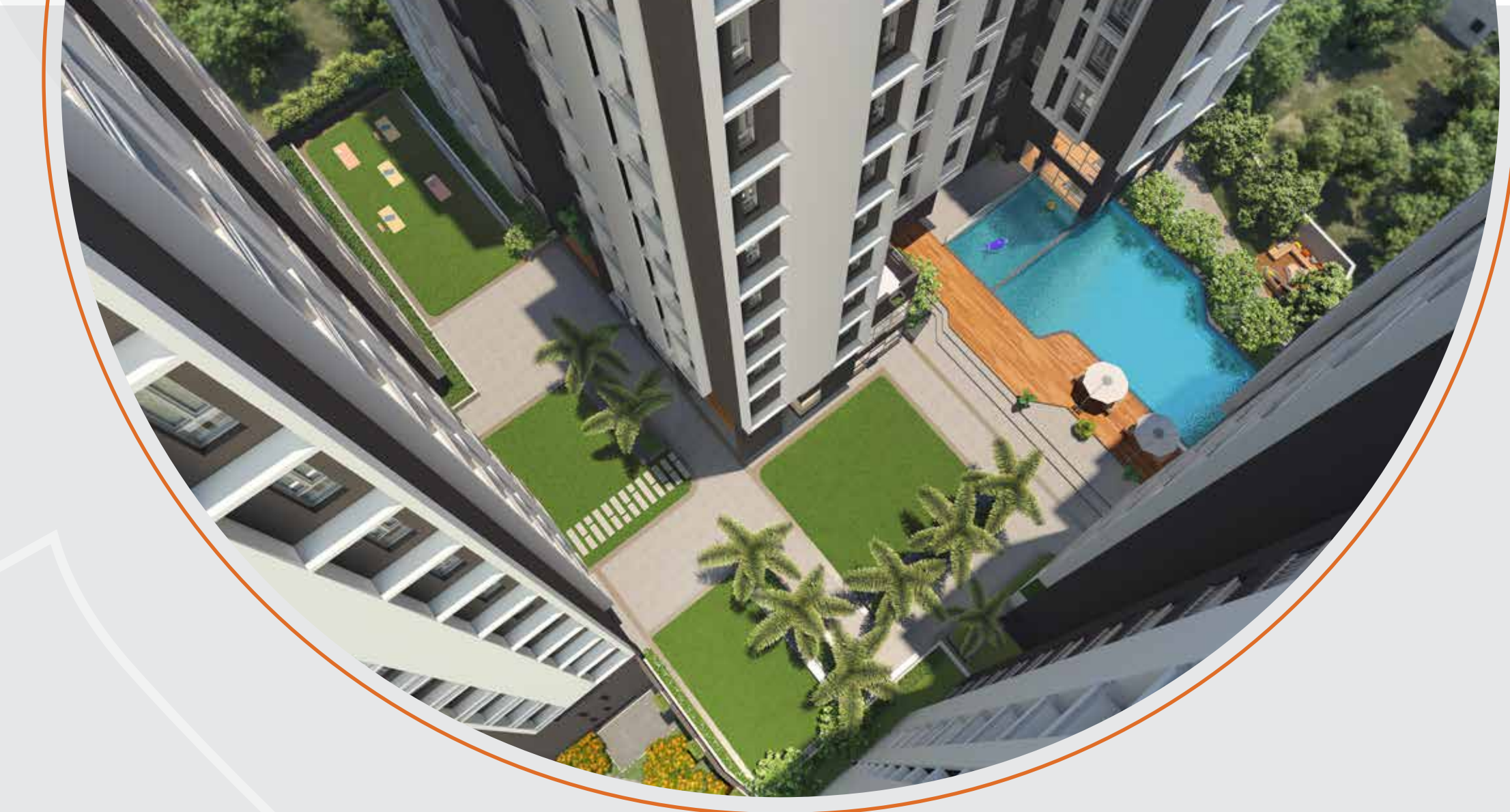



PODIUM



-  Double Height AC Gymnasium^{*}
-  Swimming Pool with Deck^{*}
-  Double Height AC Community Hall^{*}
-  Home theatre[#]
-  Meditation Zone^{*}
-  Double Height Indoor Games Room[#]



KIDS

-  Children's Play Area^{*}
-  Hopscotch Zone^{*}
-  Toddler Play Zone[#]

SPECIAL

-  Common work station (Work from home facility)[#]
-  Retail Zone (Future Phase)^{*}



OTHER

-  Power Backup[#]
-  24 Hrs Water supply[#]
-  24 Hrs Security[#]
-  Elegantly designed lobby[#]
-  Intercom Facility[#]
-  Rainwater Harvesting^{*}
-  Solar Power in common areas^{*}
-  CCTV[#]

[#]Amenities provided in Phase -I
^{*}Amenities provided in Phase -II

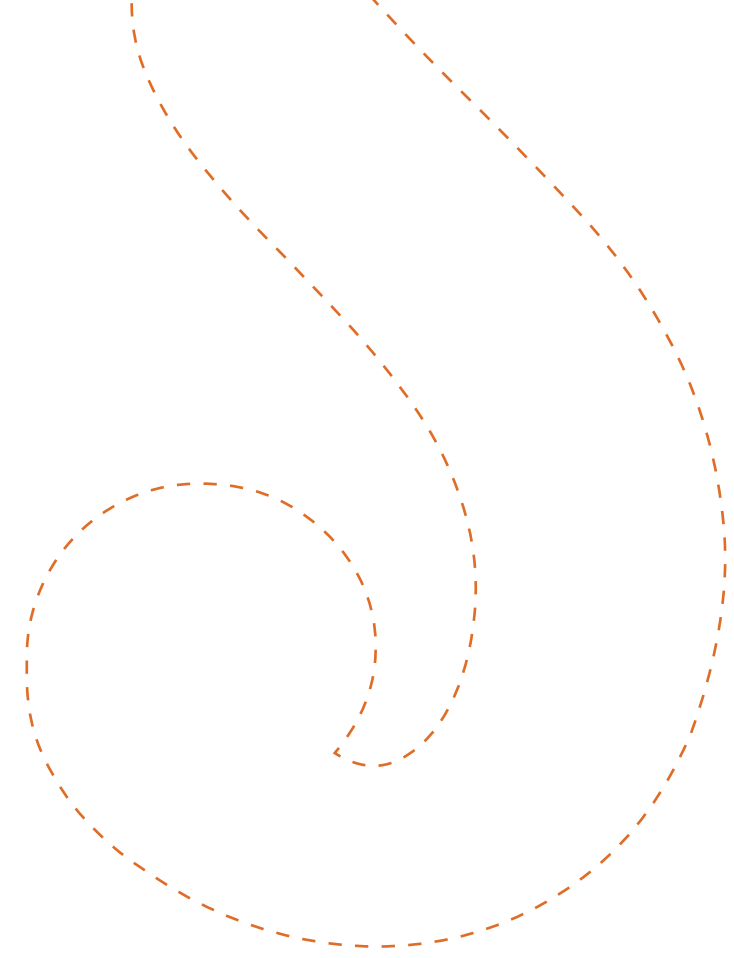

SAMBHAVANA

POSSIBILITIES BLOOM HERE

Embrace the possibilities of a peaceful, prosperous and joyous life at Sampurna! Here, home will be much more than a structure of brick & mortar. It will be where your dreams meet reality!

3 Towers | G+18 | 2/3 BHK residences

In Two Phases



SWABHIMAN

AN ADDRESS YOU WILL BE PROUD OF

Savour the pride of living at one of the most important locations of Kolkata.
 Become a BT Road resident & stay connected to major parts of the city, as well as
 schools, colleges, hospitals, malls, rail station, airport, & upcoming metro.
 Live the urban life you've always wanted.

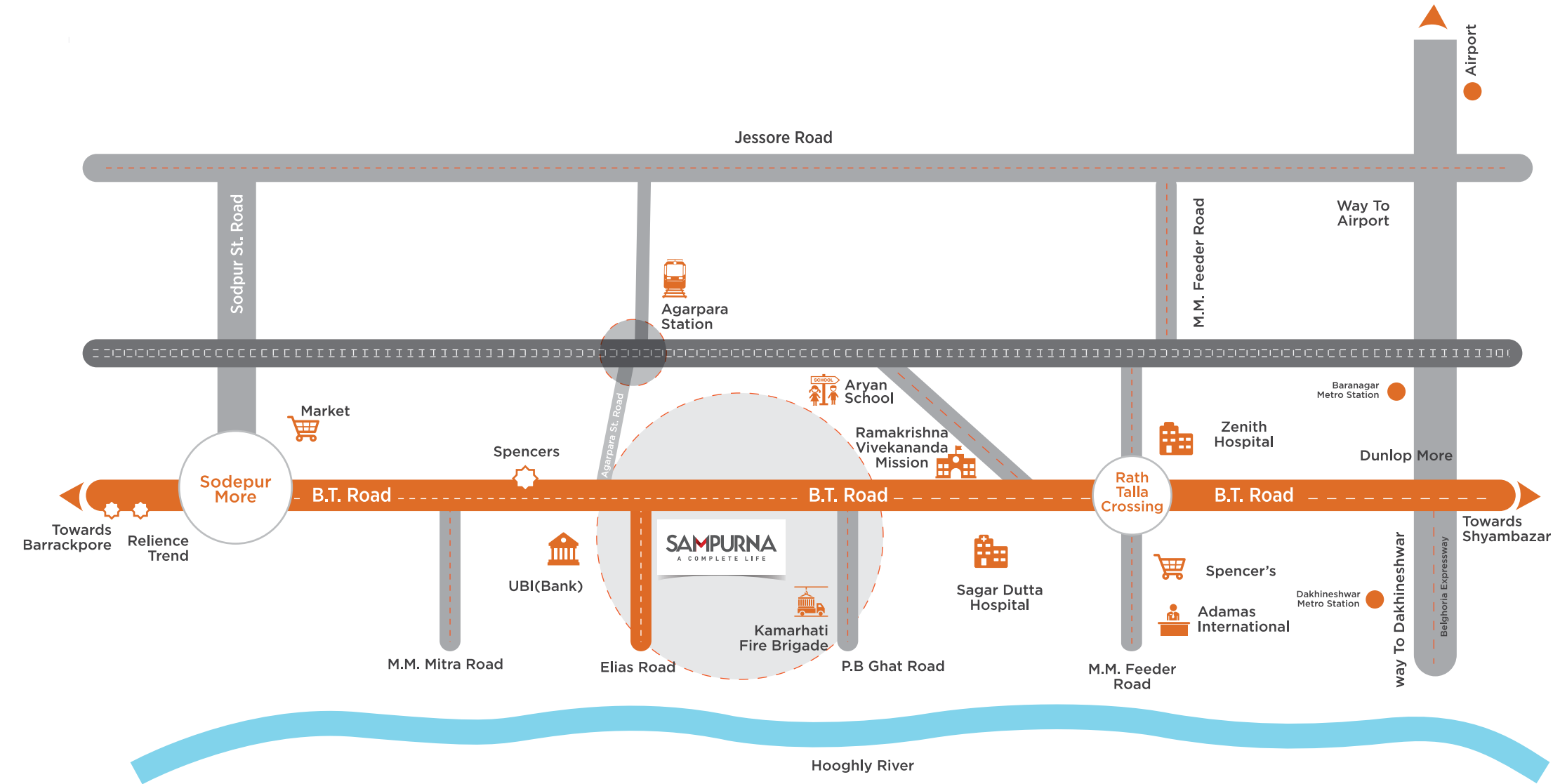

✔ Nearest Hospitals

- Sagar Dutta Medical Collage & Hospital **1.3km**
- Green View Nushing Home **1.1km**
- Zenith Super Specialist Hospital **2.6km**

✔ Nearest Schools

- The Aryans School **1.1km**
- Adamas international School **2.2 km**
- Delhi Public School, Dunlup **4.6km**

✔ Nearest Colleges

- Narula Institute of Technology **1.2km**
- Gurunanak Institute of Dental Sciences & Research **1.5km**
- Panihati Mahavidyalaya **4.1km**

✔ Nearest Shopping Destination/ market

- Vishal Mega Mart **0.45km**
- Spencer's B.T Road **2.5km**
- Max **2.5km**
- Daily convenience store at stone throw distance

✔ Railway station

- Agarpara Railway Station **1.6km**
- Sodepore Railway Station **2.1km**

✔ Metro station

- Baranagar Metro Station **3.5km**
- Dakhineswar Metro Station **4.8km**

Airport

- ✔ Netaji Subhash Chandra Bose International Airport **19.7 km**

BIRD'S EYE VIEW



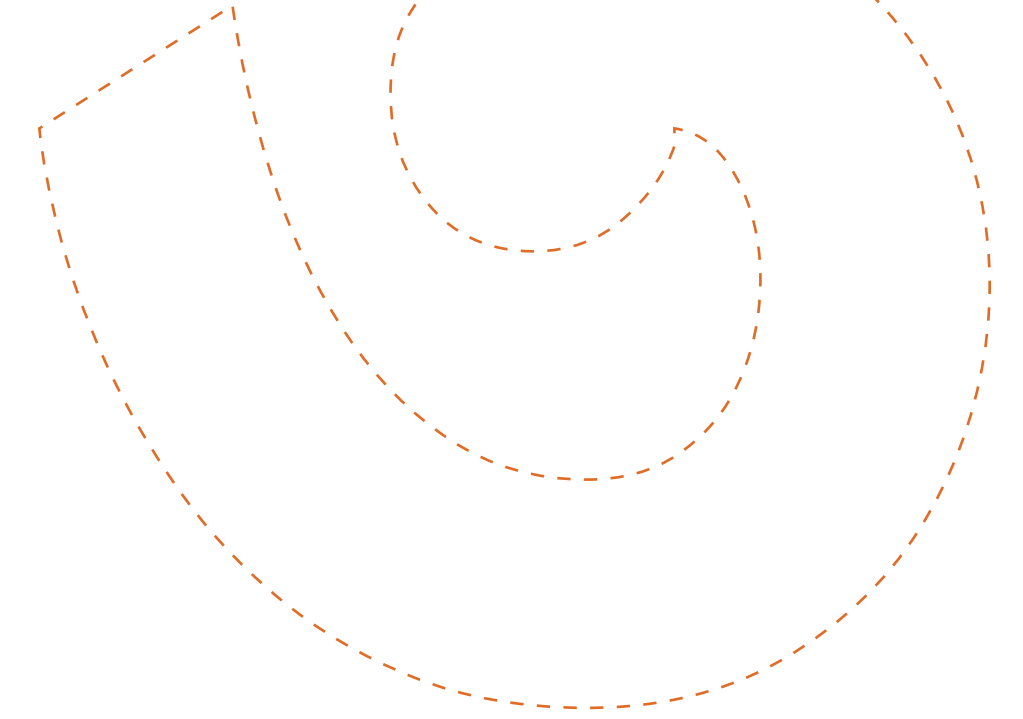

SAMRIDDI

GIVE YOUR LIFE THE PROSPERITY
IT HAS EARNED

Let your ambition take wings in the skies of
infinite possibilities. Connect with the right
people & make the best impressions!

Prosperous Beautiful Entrance



SOUNDARYA

REJOICE IN A WORLD OF BEAUTY

Feel refreshed in the world of greens. Once you enter, the greenery around and the wind coming over the natural water body will calm your mind. A walk on the nature trellis or a quiet evening spent sitting beside the water body will enhance the spirit of adults and children alike.

Natural Water Body • Garden Nature Trellis
Surrounded by Greenery • Landscaped Garden



LANDSCAPE & GREENERY

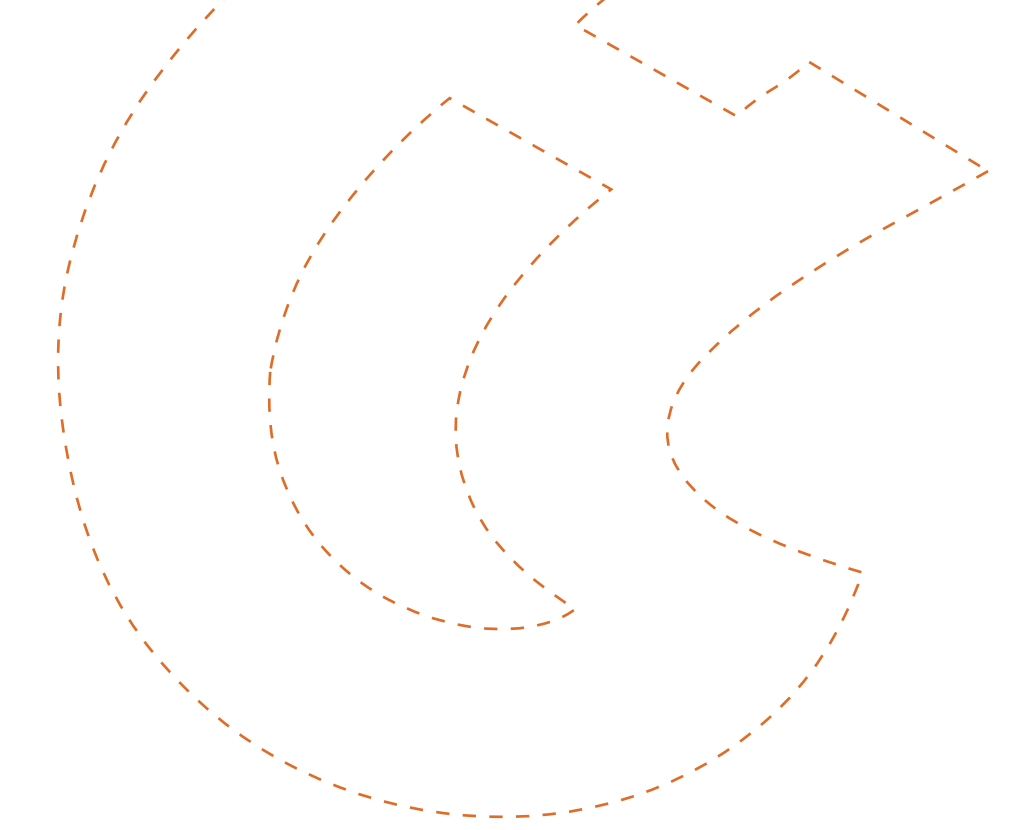

SANSKRITI

LET VALUES MAKE LIFE RICHER

Get back in touch with your roots and celebrate our heritage of togetherness. Let your days be defined by true harmony!

Senior Citizens' Seating Corner • Adda Zone

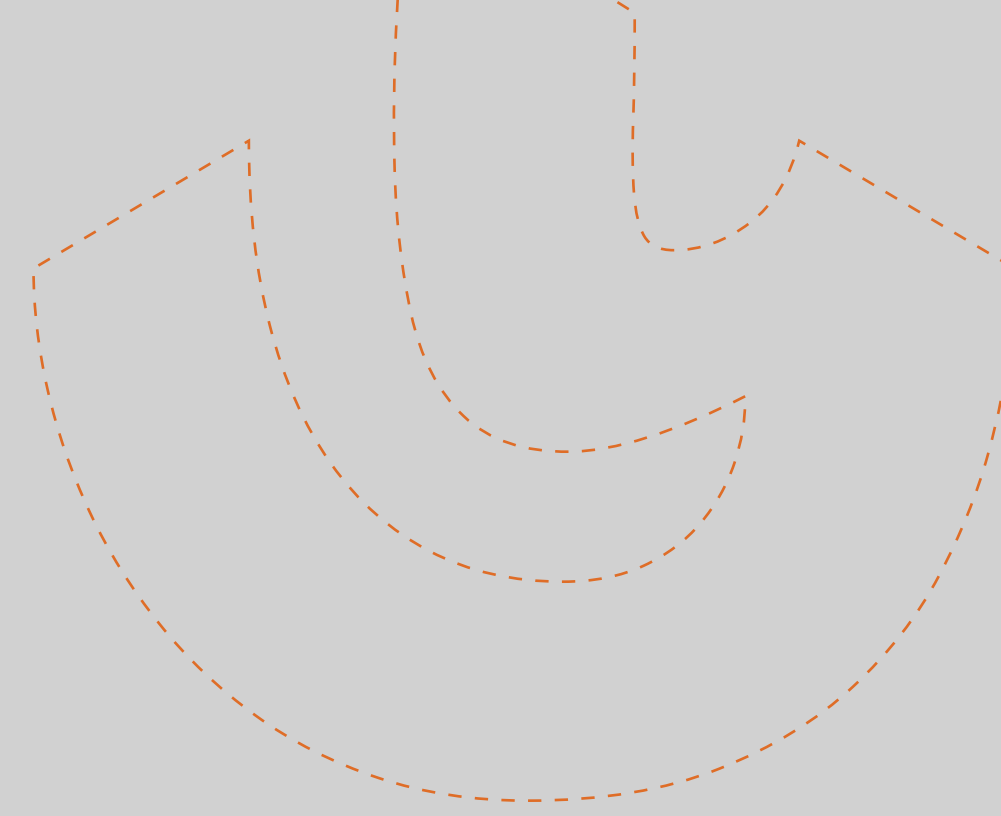

SHANTI

A PEACEFUL LIFE FOR PEOPLE DEAR TO YOU

Let your family find serenity again, within beautiful greenery, open spaces and fresh blossoms. **And** experience a blissful peace, every day!

Yoga & Meditation Lawn • Reflexology Walkway

CLUB AMENITIES ON PODIUM LEVEL

State-of-the-art amenities sprawled across
approximately 15,000+ sq. ft.

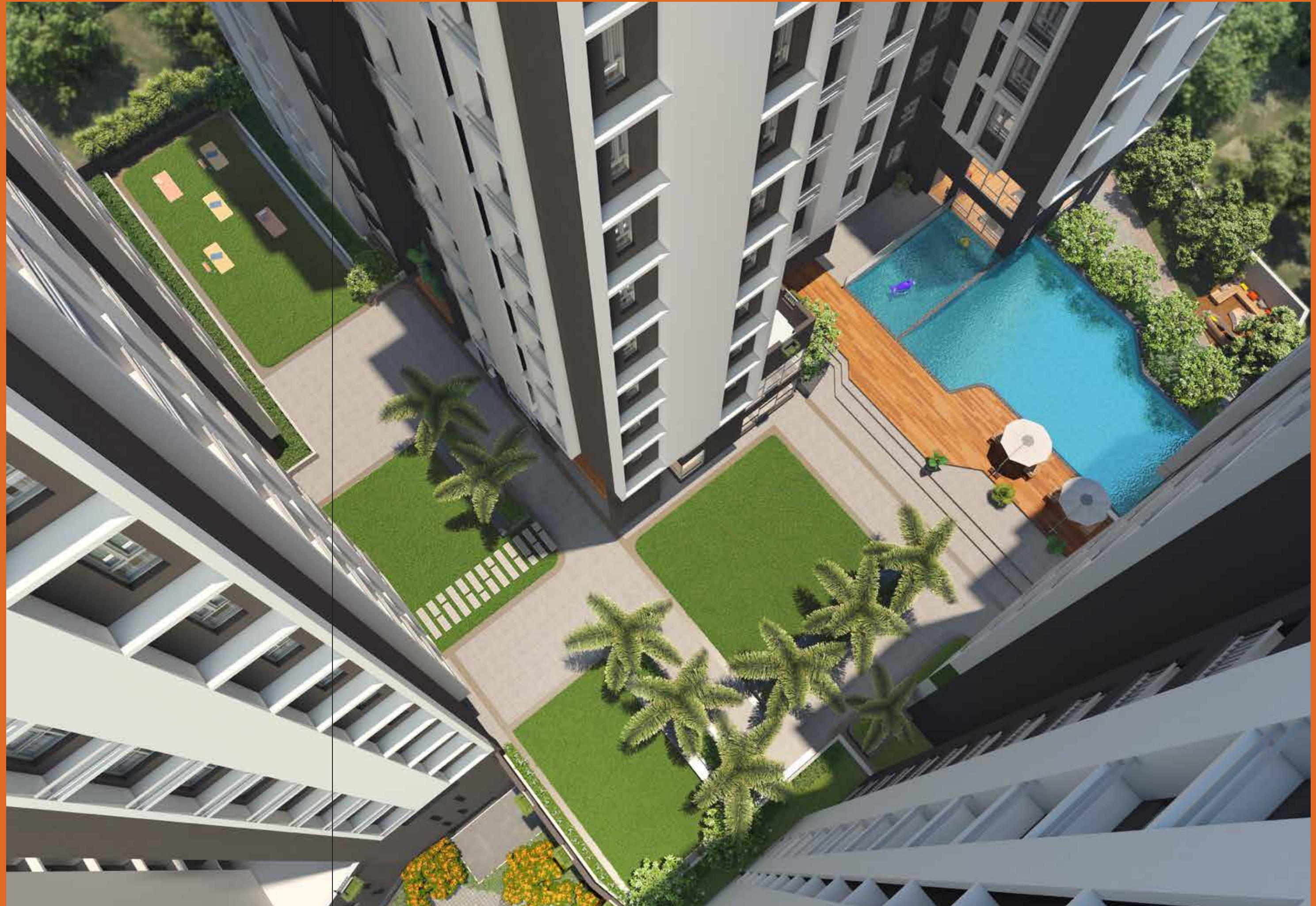

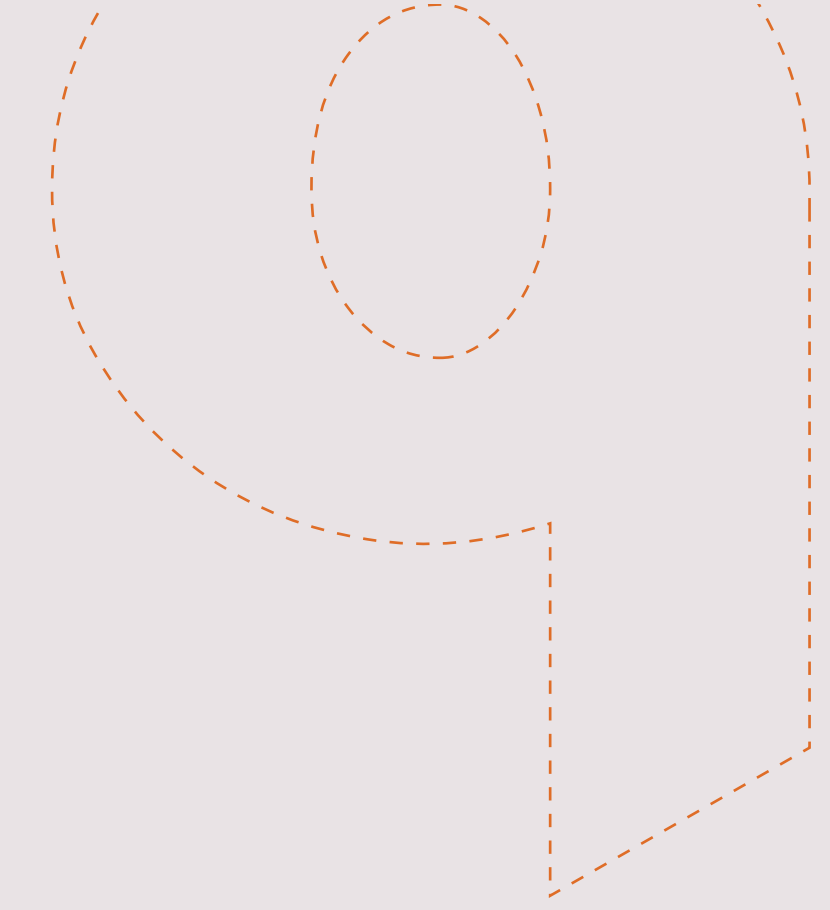

SUSWASHTHYO

GIVE YOUR LIFE THE JOY OF GOOD HEALTH

Get back on the fitness track and live a healthier life.
And live at your fittest, every day!

Double Height AC GYM

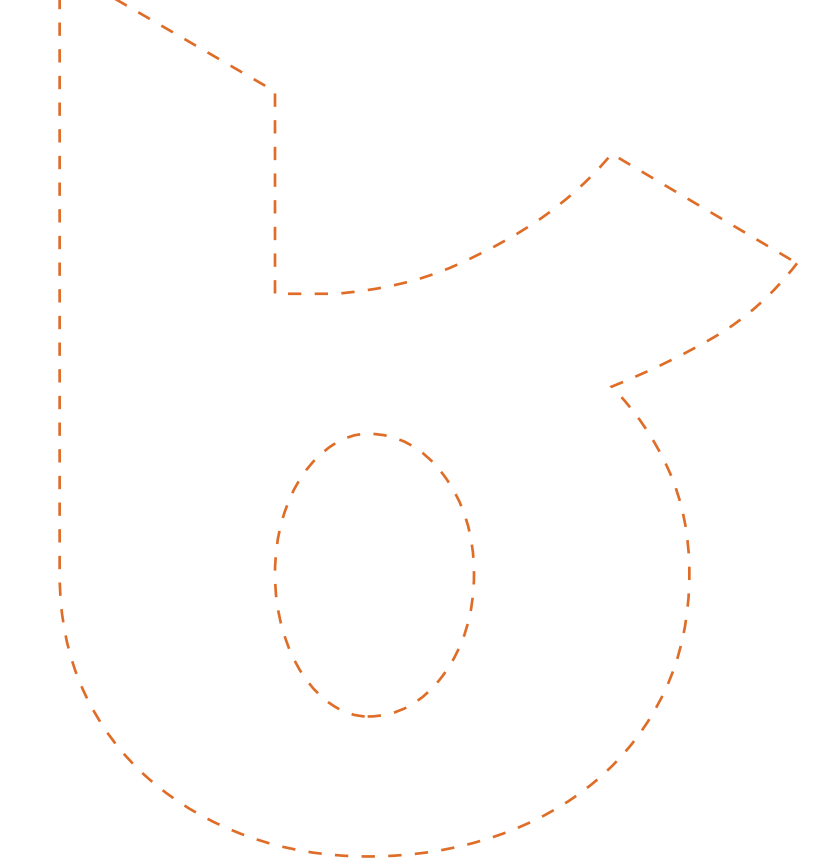
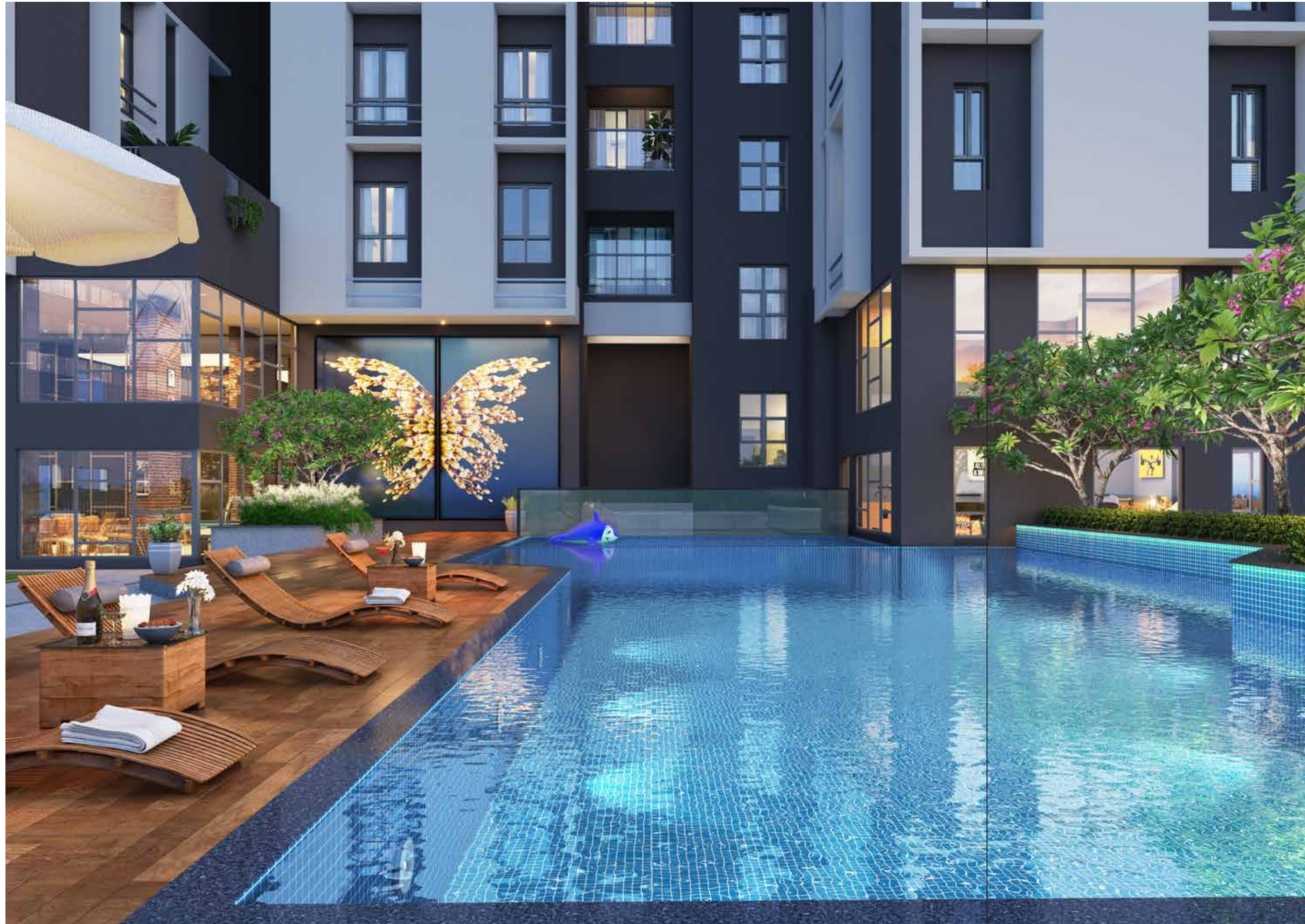

SUKH

FIND THE HAPPINESS SPLURGE

Fill your hours of leisure with pure joy. Unwind at the luxurious club inside the complex and dive into a world of bliss & larger than life moments, with your most favourite people!

Swimming Pool with deck • Home Theatre

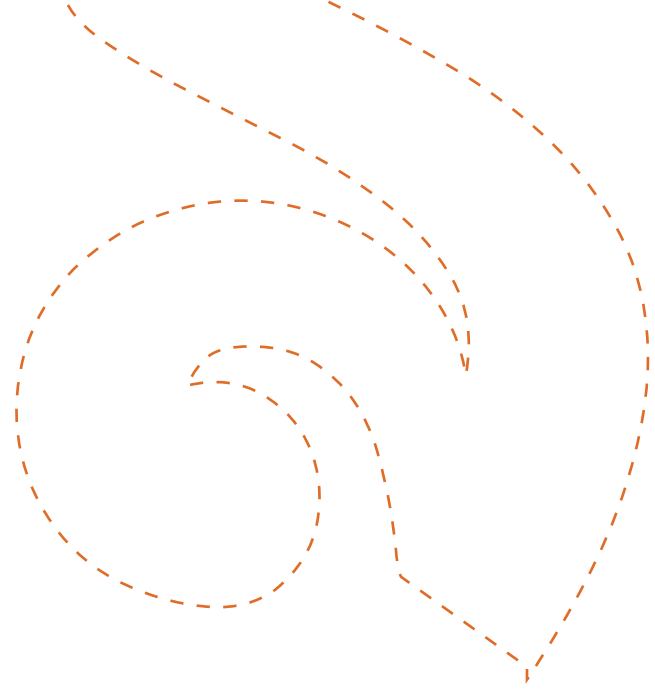

SAUHARDYA

HERE BROTHERHOOD COMES WITH AFFECTION

Connect with like minded souls and watch conversations flow. Let true camaraderie flourish in every corner!

Double Height Indoor Games Room
Open Area Board Game



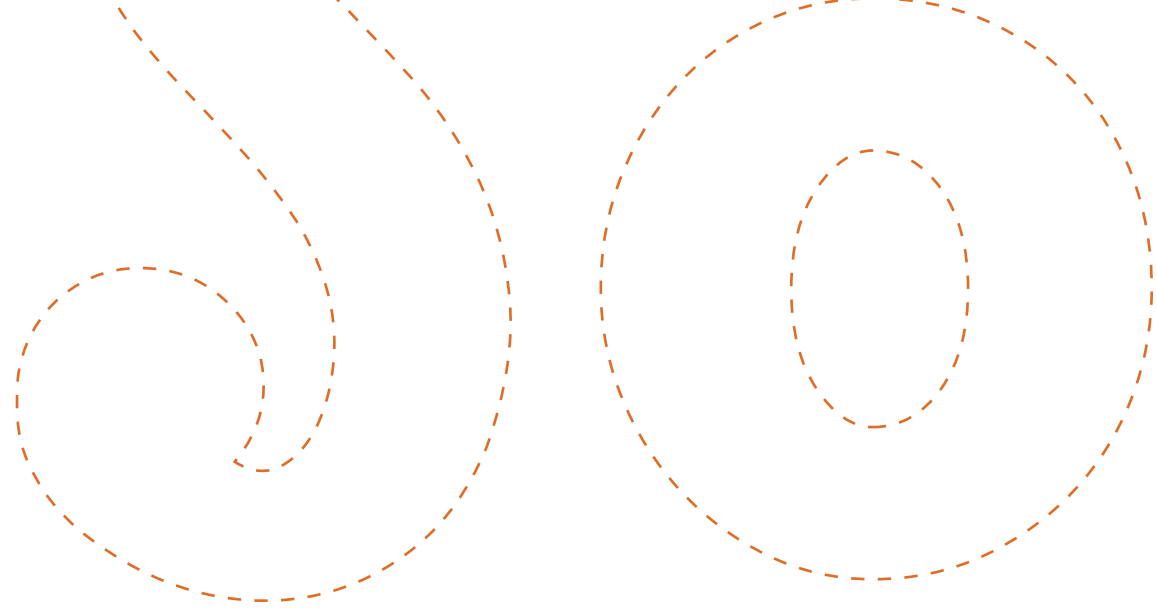

SANSKAR

LET YOUR LIFE HONOUR THE
TIMELESS CUSTOMS

Celebrate your timeless heritage and festivities
with those closest to you. **And nurture the beauty
of your traditions!**

Double Height AC Community Hall



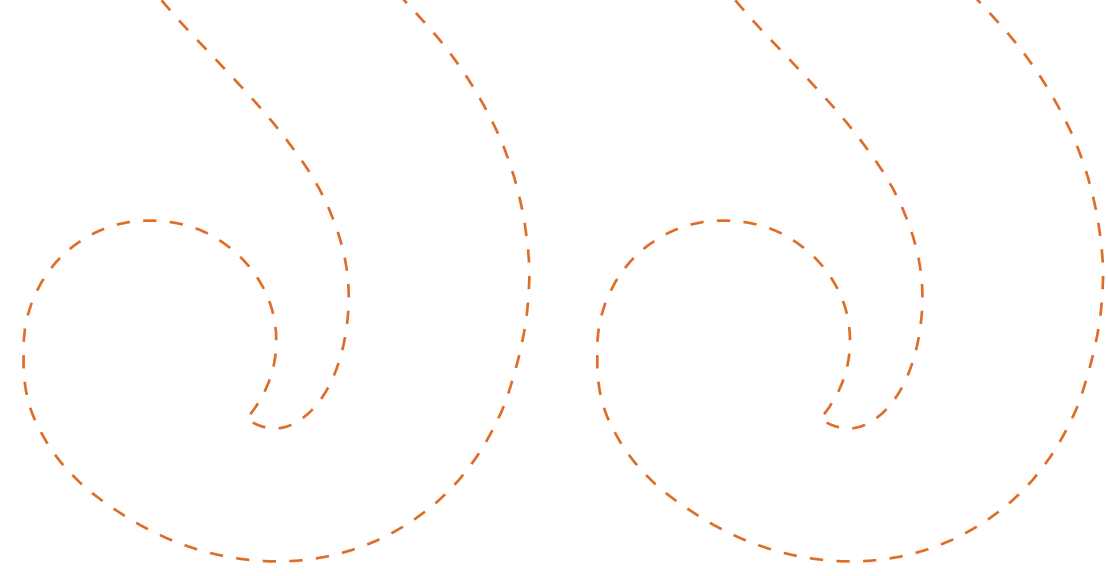

SHOISHOB

WATCH CHILDHOODS COME
TO LIFE AGAIN

Witness the innocence of childhood blossom all around you. And find true joy in hearing those happy giggles echoing in the air.

Children's Play Area • Hopscotch
Toddlers' Play Zone



KIDS' FRIENDLY AMENITIES

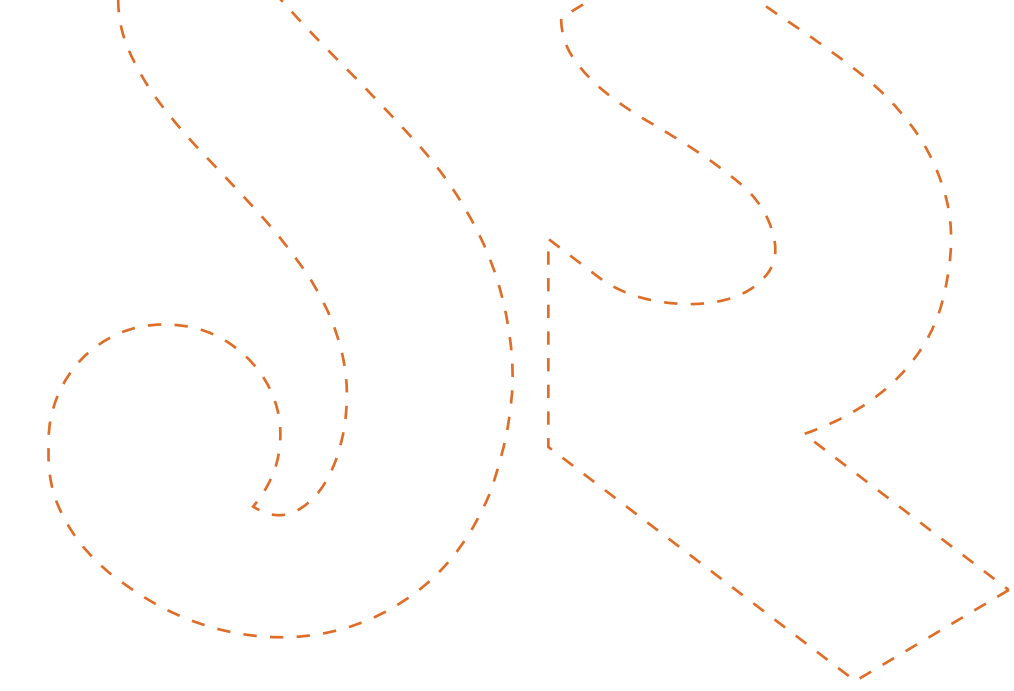

শৌকিনোতা

SHOUKHINOTA

THE PASSION FOR GOOD LIFE
WAKES UP HERE

Indulge in the little and big desires of your heart. Live life with the passion for all things wonderful & seamless!

Retail Shop (Future Phase)

SACHHANDYA

HERE DAYS UNFOLD IN
UTMOST COMFORT

Let comfort define your days and fill them with a tranquil joy. Thrive and savour the ease of having everything you need just a few steps away.

3 Lifts In Each Block (2 Passengers' Lift and 1 Service Lift) • 24 Hrs Security Power back up • 24 Hrs Water supply Intercom facility • CCTV on Ground Floor



SADHINATA

SAVOUR THE FREEDOM OF A LIFE
WITH ZERO WORRIES

Let your life flow like a seamless stream. Let nothing come in the way of an ever progressing life!

**Common Workstation
(Work from home facility)**



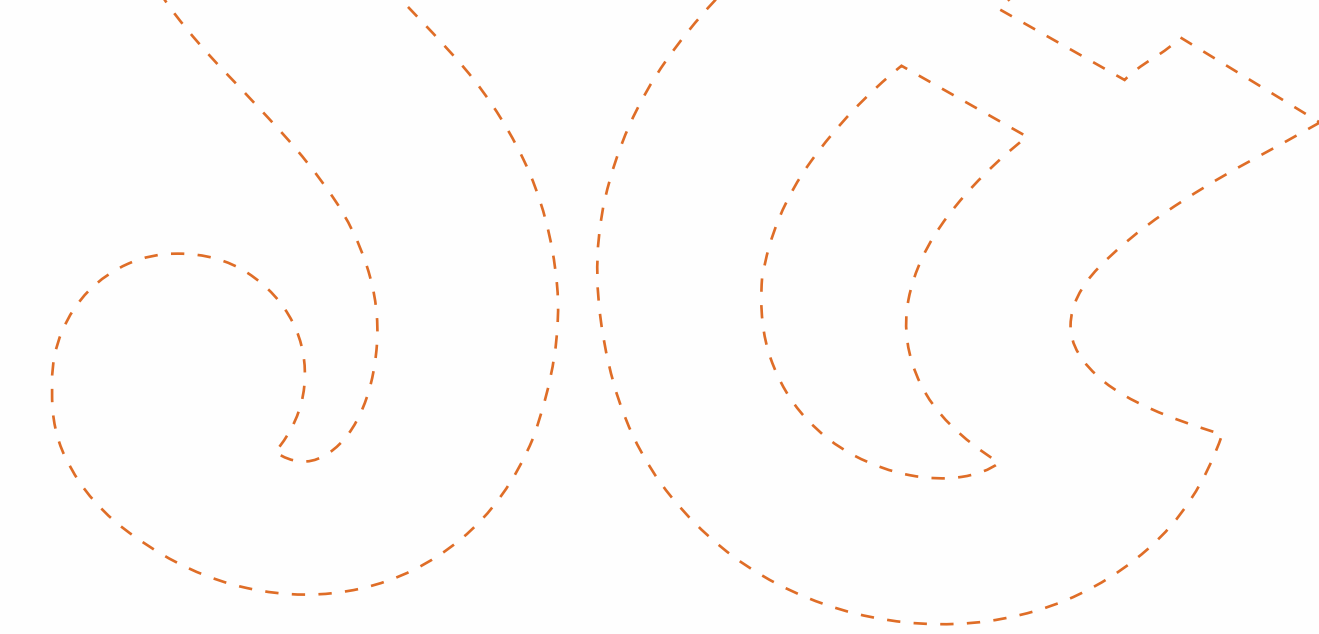

SAMPURNA

LET YOUR DREAMS FLOURISH

All that you ever dreamed of in your perfect home, watch it all come true. Sampurna brings a space where relationships thrive - be it with others or with your own self!

Well designed apartments for maximum utilization of space
Well ventilated with abundant sunlight • 2/3 BHK

SPECIFICATIONS

Structure:

R.C.C super structure with AAC block/Structural/Non-Structural wall as per design

Exterior:

Paint finish.

Interior:

Wall Putty/Plaster of Paris.

Flooring:

Vitrified tiles in living, dining & in all bedrooms.

Main Lobby:

Elegantly designed lobby and corridors.

Balcony:

Vitrified tile flooring with M.S. Railing.

Kitchen:

Polished granite top platform with stainless steel sink, glazed tiles dado up to 2 feet height above the platform. Anti-skid tile flooring in the kitchen. No door in the kitchen.

Electrical Points:

- a) Copper concealed wiring of reputed make.
- b) Modular switches with MCB & DB.
- c) AC Points: In all bedrooms, living-dining area.
- d) Telephone points in living-dining.
- e) TV Cable point in master bedroom & living-dining
- f) Geyser point in all bathrooms.
- g) Exhaust fan outlet in kitchen & all toilets.
- h) Calling Bell point at main door.

Water supply:

Water supply through filtration plant.

Lift:

Branded elevators of OTIS / Johnson or equivalent in each block.

Toilet:

Anti-skid tiles on the floor and glazed tiles on walls up to door height. Hot and cold water points for shower area. Western style white sanitary fittings of reputed make

Windows:

Sliding anodized aluminium window with glass panes.

Doors & Frames:

Wooden door frames. Decorative laminated finish main entrance flush door with lock & eye piece. Internal flush door with primer coating on both sides.

Hardware:

Good quality C.P. fittings.

Intercom System/CCTV:

Intercom facility connecting security room only.
CCTV at ground floor level.

Fire Safety Norms:

Modern fire fighting system as per WBFES.

Solar Backup:

Solar backup as per Govt. norms, in phase II

Local Cable & Broadband:

Central distribution box at ground floor with wiring upto flat DB box.

DG Power Backup:

24hrs power backup for common area & emergency power back up for flats (As per charges applicable, depending upon flat size).

Rainwater Harvesting:

As per Govt. norms, in phase II

STP: As per Govt. norms, in phase II

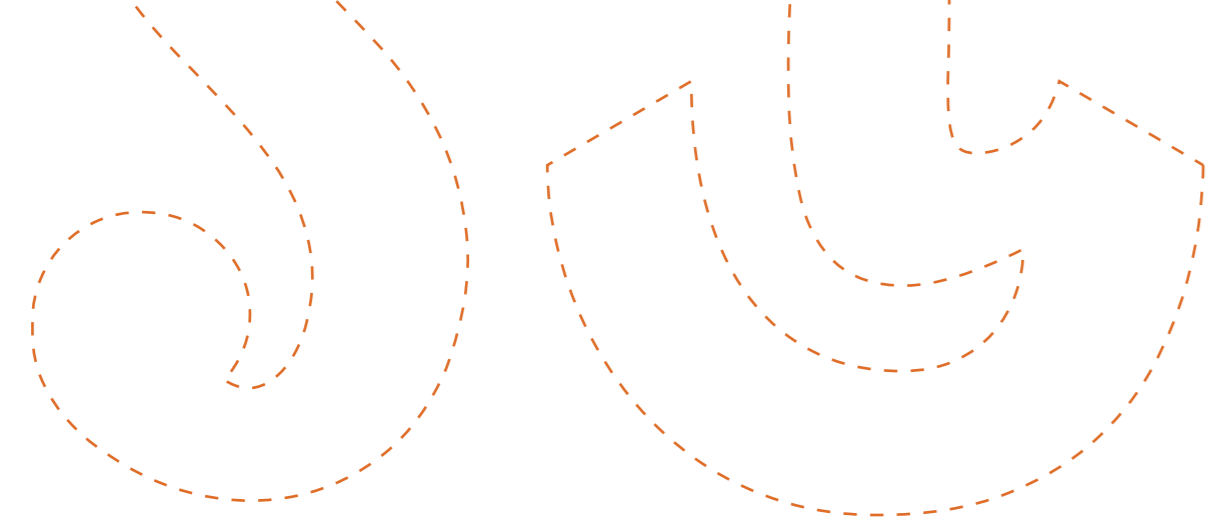

SREEJONI

FLOOR PLAN



MASTER PLAN

- 1 Entry/Exit
- 2 Commercial Space (Future Phase)
- 3 Cricket Pitch*
- 4 Parking
- 5 Meditation Zone*
- 6 Grass Lawn with Planter Sitting*
- 7 Swimming Pool*
- 8 Children's Play Area*
- 9 Senior Citizen's Corner*
- 10 Water Body*
- 11 Sitting Area with Tree Plantation*
- 12 Reflexology Walkway*
- 13 Yoga Lawn*
- 14 Cantilevered Sitting Area*
- 15 Adda Zone*
- 16 Flower Garden*
- 17 Board Game*
- 18 Hopscotch Zone*
- 19 Drop Off*

- 2 BHK
- 3 BHK
- 3 BHK Premium

*Amenities provided in Phase -I

*Amenities provided in Phase -II

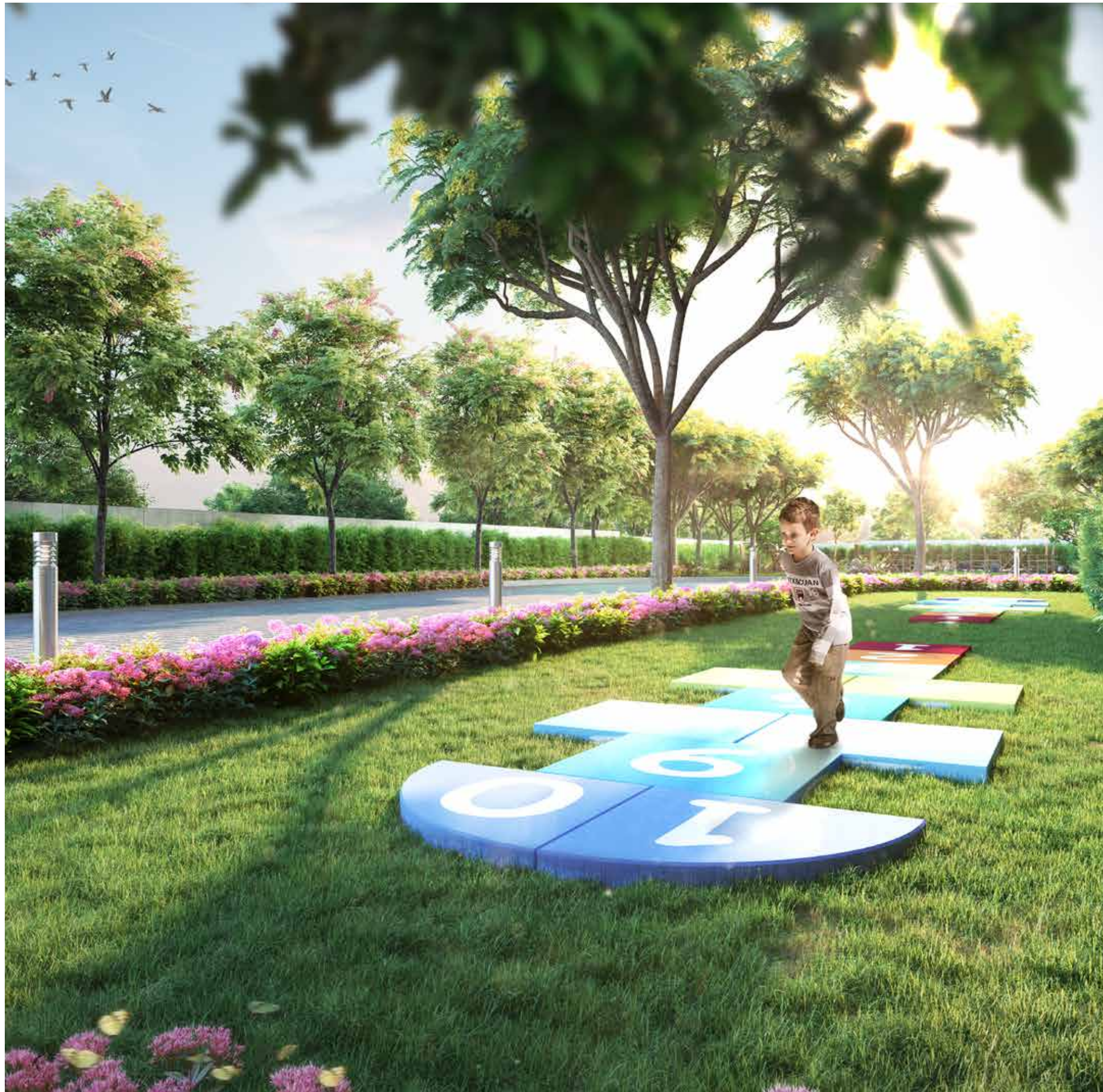

**3rd FLOOR PLAN
PODIUM LEVEL**



**TYPICAL FLOOR PLAN 5th-18th
Wing - 2**



TYPICAL FLOOR PLAN 5th-18th
Wing - 3

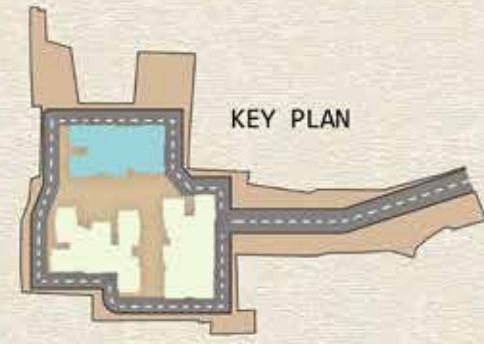

Flat	Type	Flat Carpet	Balcony Carpet	Cupboard Area	Built Up Area	Chargeable Area
1	3 BHK	646	34	22	762	995
2	2 BHK	552	34	15	661	863
3	3 BHK	646	34	20	763	997
4	3 BHK	646	34	20	758	990
5	2 BHK	530	31	16	635	830
6	3 BHK	647	32	23	767	1002



AWARDS & RECOGNITION

- Iconic Project of the year by Realty Plus Conclave & Excellence Awards East 2018 Cloud 9 Off Alipore
- Residential project of the year by Realty Plus Excellence Awards 2020 Windmere Madhyamgram
- Luxurious Project of the Year - 2019 by Realty Plus Victoria Vistas D.L. Khan Road
- Recognised by Consumers & Industries (Asia One) as India's Greatest Brand 2018
- India's Top 100 Affordable Housing Projects by Realty Plus Parkwoods Estate Mankundu
- Brick & Mortar Award for Best Residential Project Heritage Mayfair Ballygunge
- Recognised by SDF International as Most Promising Developer of the Year, East 2018
- Recognised by Consumers & Industries (Asia One) as India's Greatest Brand 8 Leader 2018
- Best Upcoming Affordable Housing Project in Kolkata by Asia Real Estate Excellence Awards 2018 Windmere Madhyamgram
- CNBC Real Estate Award for Best Residential Project in Eastern Region Sherwood Estate NSC Bose Road, Narendrapur
- Best Residential Upcoming Project Award from CREDAI Realty Awards 2019 - Vinayak River Links, Howrah & Hooghly
- Praxis Media awarded STEM WORLD School as the Best K-12 International School In Eastern India
- Budget Housing of the year by Realty Plus Excellence Awards 2020 (East) Suncrest Estate Southern Bypass



SIGNUM GROUP has been successful in delivering eminent projects before and on-time across Kolkata. Based on its iconic credentials, Signum Group today signifies signature living. The group is now also focused to set landmarks across the Hyderabad city with its unsurpassed services and quality products.



Signum Aristo



Signum Parkwoods Estate

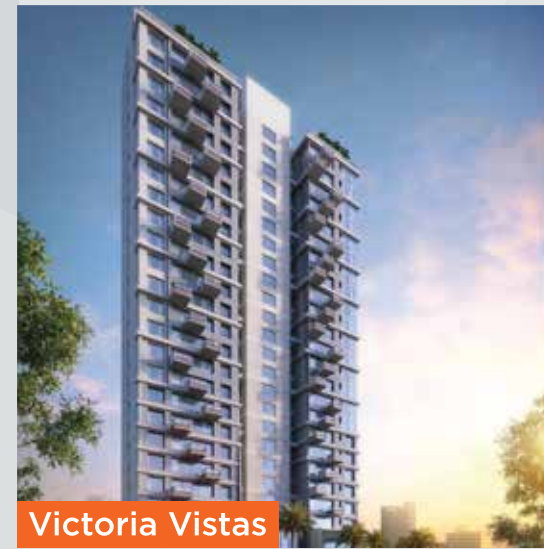

Victoria Vistas



Heritage Mayfair



Signum Gardenia



Sherwood Estate



Cloud 9



Windmere



Stem World School



JAI VINAYAK GROUP today is a fast growing real estate organisation in eastern India. The Group has defined the real estate growth in and around Kolkata through the development of various unique real estate constructions. Jai Vinayak Group is also constantly working towards improvement and growth with focus on welfare of the people. It is also equally attentive and looks to build relationships with its customers and business partners. Jai Vinayak Group has a very long way to go and it promises to keep all its commitments and bring even better projects in the future for the betterment of its existing customers, form a partnership and develop relationship with new customers and for the interested investors.



Astha Vinayak



Kohli Mansion



Shree Vinayak



Shri Shyam Sadan



Vinayak Barsha